

## Instruction for FEDOUR Heaters

Model Numbers:

HP-605, HP-608, HP-628, HP-600, HP-668, M3, M3L, M7, M8, HT-2025, HT-2050, HT-2100, HT-2150, HT-2200, HT-2300

Thanks for purchasing our heater thermostat. This thermostatic heater is manufactured from the highest quality materials and uses the latest aquarium heater technology.

We trust that you will be pleased with its accuracy, reliability and safety; but this product has been transported halfway around the world to reach you. On its journey it has travelled on ships and trucks, and been in and out of many warehouses. There is therefore a remote possibility that it could have been damaged, or inexplicably broken in transit. **The probability of this happening is extremely small but impossible to completely avoid, and we suggest that you visually check your heater and ensure that it is in good condition before using it.**

If you are not happy with the product, or if you have any questions about the product's operation, please contact us as soon as possible. We will always try our best to provide you with a satisfactory solution.

**Our after-sales service team are always here at your service:**

**#1 Mail: [aquaservice@163.com](mailto:aquaservice@163.com)**

**#2 Mail: [aquaservice@yeah.net](mailto:aquaservice@yeah.net)**

We suggest that you write to both of the above emails at the same time to ensure that you get a quick response. We will normally reply in between 1 and 8 hours; which is very fast considering the time lag.

As a serious manufacturer of aquarium equipment, our mission is to provide suitable and reliable products for our aquatic friends. If you have any suggestions for improving any of our products, please do not hesitate to contact us; we are willing and eager to consider your ideas and suggestions.

Thank you again for choosing our product. We are so glad that we share the goal of providing our aquatic pets with a perfect environment.

**Please follow these instructions when installing and using your thermostatic heater:**

### **Installation instructions**

1. Fasten the enclosed suction cups onto the thermostatic heater and set it up in the aquarium (Please refer to the important safety precautions below). **To ensure that the best water temperature regulation is achieved, place the thermostat where the water is continuously circulating. This is normally near to a filter or water pump.**
2. Turn the temperature adjustment knob to set the required temperature. We suggest slowly raising the temperature from lower than required to the desired one. (For example: if the required temperature is 28°C/82°F, then the temperature should be adjusted from 26°C/78°F or less).
3. **Make sure that the heater is completely immersed in the water, then insert the electric plug into the power socket.** The thermostat will take several minutes to register the water temperature. The device switches on or off as soon as the tank's water temperature deviates  $\pm 1^{\circ}\text{C}$  from the temperature set on the thermostat so that the water temperature is kept at

a constant level. The indicator light turns on when the heater is heating, and will turn off when the temperature reaches the programmed level. There may be minor differences noted between the thermostat's and the tank's thermometers. This is normal and expected.

4. Once the heater has been installed, it will automatically keep the water temperature stable, so you can simply "set and forget", leaving it to maintain the selected water temperature, and leaving you to enjoy your aquarium. However, we suggest that you pay particular attention to the changes in the water temperature during the first week to ensure that everything is working as expected.

### Maintenance

To maintain efficient heating please periodically clean any calcium build up from the glass tube. **Before you clean it or remove it from the water, you must unplug the heater and wait for 15 minutes to ensure that the heater has cooled down.** Normally the parts of the heater that touch the suction cups need the most cleaning. Do not use any detergent, solvent or acid to clean the heater.

### Safety Regulations

#### Important Precautions:

1. This thermostatic heater is for use in indoor aquariums only. The thermostatic heater cannot be switched on until the power unit has been immersed entirely in water.
2. Fit the suction cups to the heater and set up the aquarium according to the installation diagram below:

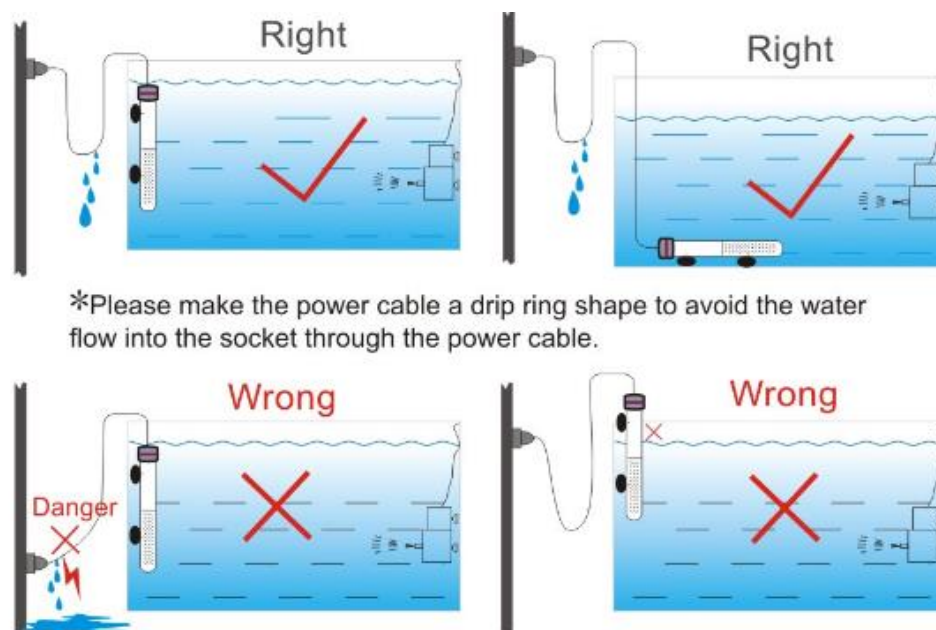

3. The heater can be fixed horizontally or vertically where the water circulates freely. The light should be positioned so that this can be seen clearly.

4. The electric cable from the thermostat to the plug should have some slack in it, so that the lowest point on the cable is lower than the plug socket. This will prevent any water from the tank from flowing (or dripping) into the plug socket.

5. Usually 2 suction cups are sufficient for setting up the heater. A spare suction cup has been included in your kit in case you should need a spare one. Please do not attach the suction

cups directly to the heater since this might damage the cup. Please also keep the heater and suction cups clean. Excessive dirt and calcium build up can prevent the heat from dispersing, which can cause inefficient tank heating and damage to the product.

6. Do not pull the heater adjustment knob outwards.

7. Before putting your hands into the water for any reason, turn off the power to the thermostatic heater and all the other electrical devices in your aquarium!

8. The cable cannot be replaced. If the cable is damaged then the device should be discarded.

**Warning: Please keep this product away from children under 18 years old.**

**Manufacturer: Zhongshan Ibay Electric Appliance Co., Ltd**

**Manufacturer Address: 3rd, No.6 Shunmin Road, Jixi Xiaolan Town, Zhongshan, Guangdong, China**

**E-mail: [aquaservice@163.com](mailto:aquaservice@163.com)**

**[aquaservice@yeah.net](mailto:aquaservice@yeah.net)**

**We will be always on your service!**